

MODU-MAX[®]

CTS
(CONTAINER / TRAY STORAGE)



DISTRIBUTION*Systems*
INTERNATIONAL

MESSAGE FROM THE PRESIDENT

Our mission is simple: DSI will continue to provide new innovative competitively priced materials handling, storage and distribution systems to the healthcare market backed by outstanding service.

We will continue to offer a comprehensive listing of products with a proven history of success as well as introduce new innovative systems that will make use of all the latest technology. These will be made available to our customers at factory direct pricing. Many hours are spent developing products that are designed to meet our customer's unique needs. Backing these will be our many value-added service packages that lead the industry. CAD drawings, sample products, DSI crew assembly and installations, emergency 24 hour delivery...to mention a few. We are a one-stop project center.

For twenty-two years, DSI has demonstrated our extensive capabilities across the nation. We will not sit on our laurels but strive to constantly improve our products and services to the healthcare market. That is our goal.

Peter Lane
President DSI, Inc.



Modu-Max CTS' modular storage systems provide customized solutions based on individual customer's needs. Our experienced professional sales force will help your facility identify areas of improvement for your supply chain. They will provide suggestions that will improve the interaction of your staff with the supply chain and it's processes.

Modu-Max CTS' mobile modular storage can be used throughout your hospital to aid in standardization and the improvements that will bring. These ergonomically designed racks are lightweight but strong and easy to handle.

Their utilization provides:

- Better storage capacity allowing more stock volume per square foot
- More organized stock which will reduce inventory values
- Greater accessibility to stored product saving time and labor costs
- Multi-functional and flexible allowing them to be used in a variety of ways and means
- Provide consistent stock rotation reducing expired product
- The possibilities are endless. Let one of our sales staff provide you with an evaluation of your facility. Find out how Modu-Max CTS can help you save money and improve your supply chain.



MODU-MAX[®]
CTS



1. Frame Uprights - Frame uprights are made from tooled aluminum anodized tubing, 1 1/2" x 1 1/2" in diameter, for superior strength yet allowing the frame to be extra light. The aluminum also prevents corrosion, paint flaking and/or chipping.



2. Rubber Strips - Frame uprights contain a front runner strip. This one-piece rubber strip helps prevent denting, chipping or scraping of misguided carts and product.



3. Stabilizer - Aluminum stabilizer cross members are made from 18 gauge aluminum to ensure stability and added strength, yet keeping the frame very light.



4. Front and back supported frame uprights - Frame uprights have two aluminum front to back supports for added stability.



5. Full Extensions - Heavy duty ball bearing glides extend 110% allowing access to the entire tray when completely pulled out. Runners will automatically pull themselves back in the last 1 1/2 inches. Load capacity is 45 lbs. per shelf.



6. Pull Handle - Trays have full length pull handles allowing for easy access to product. Trays have powder coated solid galvanized surface.



7. Retaining Walls - 1" rear and side retaining walls on the trays ensure product will remain in place while trays are opened and closed.



8. Caster - All casters are 3" swivel polyurethane braking double wheel for heavier load capacities.

Modu-Max® "CTS" Open Rack Unit

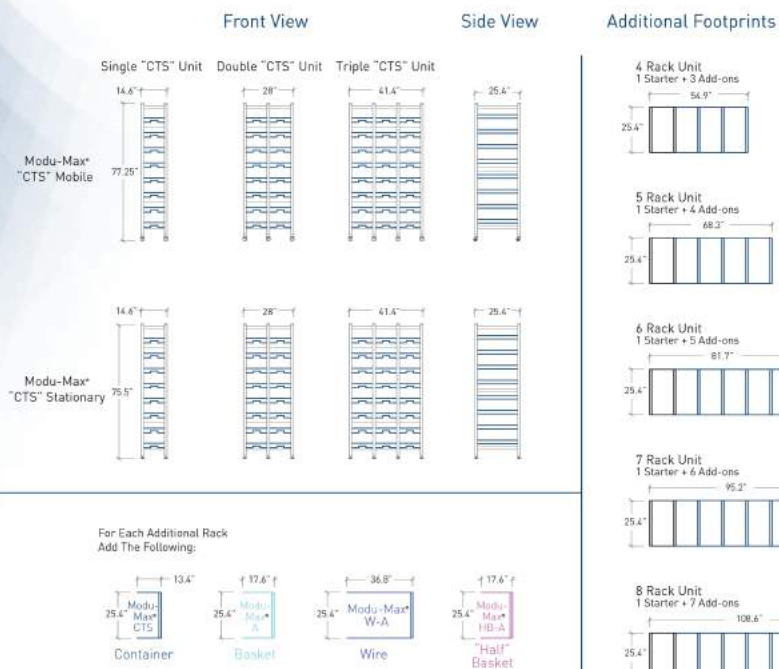

MM-KITCTS/ST/8-TELE



MM-KIT2CTS/8-TELE



MM-KIT3CTS/8-TELE



MM-KITCTS/ADD/8-TELE

Modu-Max™ "CTS-OS" Open Rack Unit

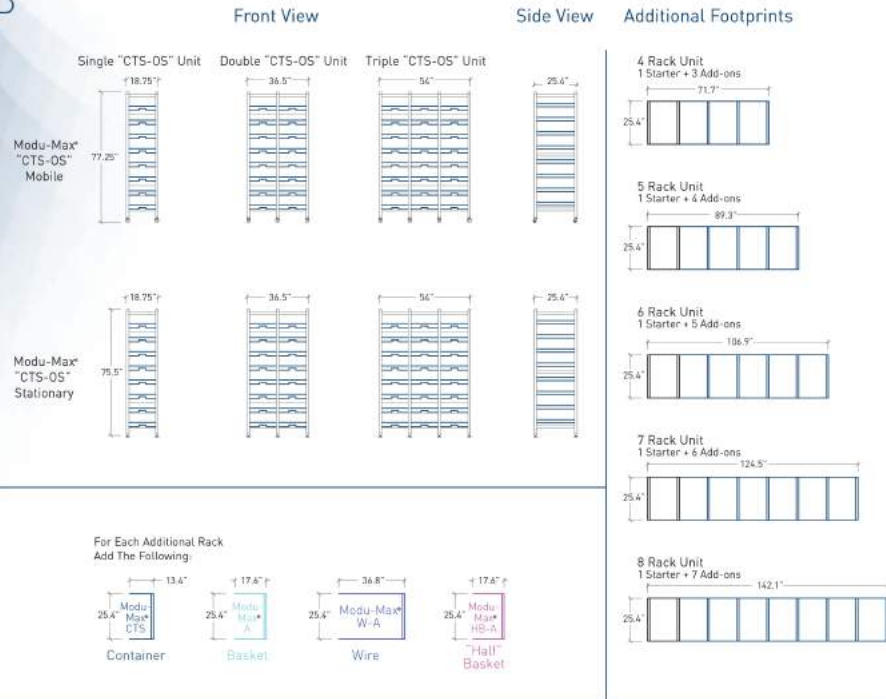

MM-KITCTSOS/ST/8-TELE



MM-KIT2CTSOS/8-TELE



MM-KIT3CTSOS/8-TELE



MM-KITCTSOS/ADD/8-TELE

Modu-Max® "CTS" Additional Options

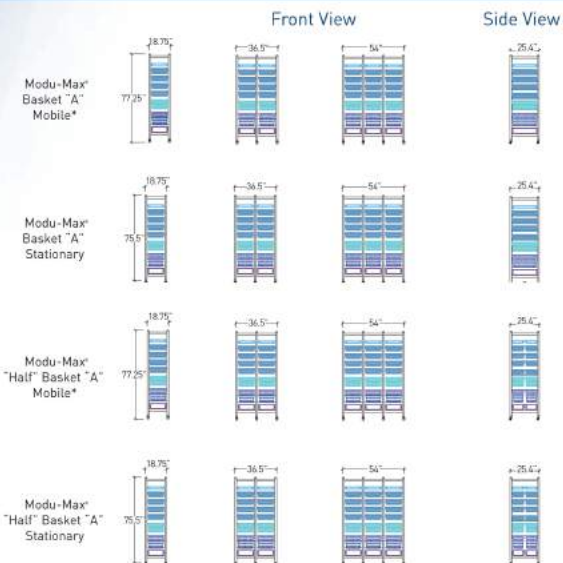
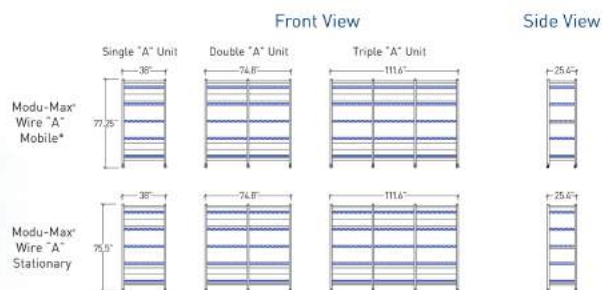

Additional Footprints

For each additional rack add the following:



MM-KITA/ST/WIDE



MM-KITA/ADD/WIDE



MM-KITHALF/ST/8BSK-C

*Available in GRAY

MM-KITHALF/ST/8BSK-G



MM-KITHALF/ADD/8BSK-C

*Available in GRAY

MM-KITHALF/ADD/8BSK-G

*It is not recommended to have more than 2 add-ons for mobile units.

Benefits



1. Slanted Top - Slanted top will not allow product to be stored on top of cabinet allowing you to maintain minimum required clearances. Also allows for easy cleaning.



2. Adjustments - Heavy duty one-piece vertical uprights with welded horizontal struts. Vertical uprights are slotted at 1" increments for placement of roll-out trays.



3. Full Extensions - Heavy duty ball bearing glides extend 110% allowing access to the entire tray when completely pulled out. Load capacity is 440 lbs. per shelf.



4. Pull Handle - Trays have full length pull handles allowing for easy access to product. Each tray has solid galvanized insert panels and 1 3/4" rear and side retaining walls ensuring product will remain in place while trays are opened and closed.



5. Lock System - Individual drawer latches lock roll-out trays closed. Finger pull latches are recessed and mounted on right side of drawer.



6. Label Holder - Plastic hinged label holder adheres to face of shelf to allow identification of shelf contents. 1 3/16" high.

Modu-Wall® "CTS HD" Closed Unit

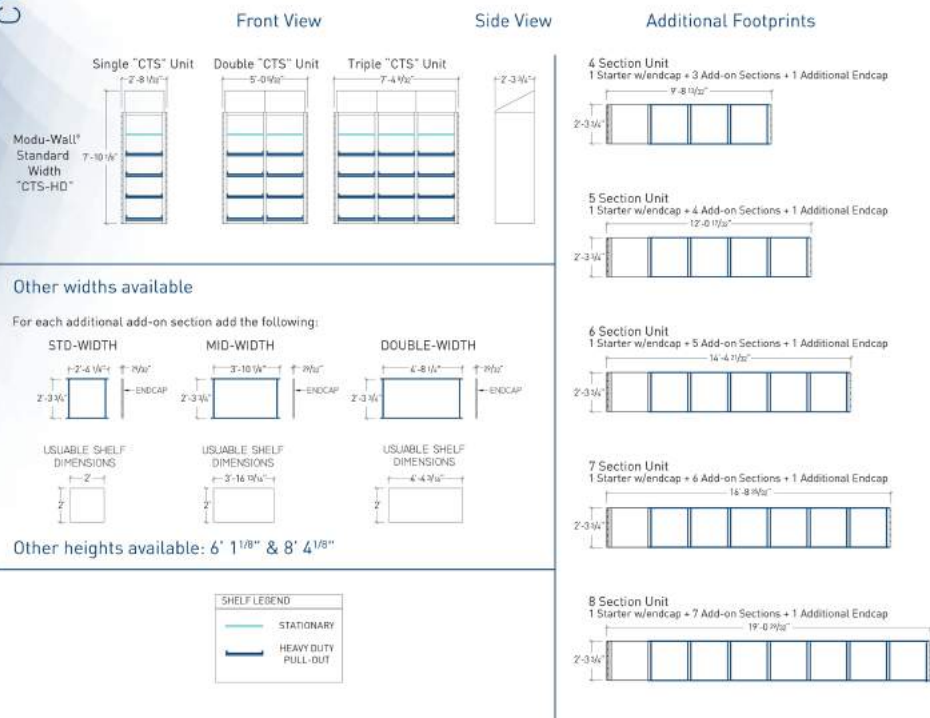

MW-KITCTSHD/STS/5-TELE
MW-KITCTSHD/STW/5-TELE
MW-KITCTSHD/STDW/5-TELE



MW-KIT2CTSHD/S/5-TELE
MW-KIT2CTSHD/W/5-TELE
MW-KIT2CTSHD/DW/5-TELE



MW-KIT3CTSHD/S/5-TELE
MW-KIT3CTSHD/W/5-TELE
MW-KIT3CTSHD/DW/5-TELE



MW-KITCTSHD/ADDS/5-TELE
MW-KITCTSHD/ADDW/5-TELE
MW-KITCTSHD/ADDW/5-TELE

Basket Stop - BS



U's - U



T's - T



Basket Inlay - LINER



Labels - LBL



Modu-Max Label - MMLB



"A" Left & Right Horizontal -
MLDH & MRDH
"A" Left & Right Angled -
MLDA & MRDA



Dust Cover - Available for Single,
Double and Triple Sections



A Single - DCA1 CTS Single - DCCTS1
A Double - DCA2 CTS Double - DCCTS2
A Triple - DCA3 CTS Triple - DCCTS3

Flat Wire Shelf A (Fits A-Units) -
WSA
Flat Wire Shelf CTS (Fits CTS-Units) -
WSCTS

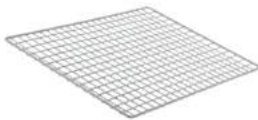

Flat Shelf Volkren A (Fits A-Units) -
VOLKRENA
Flat Shelf Volkren CTS (Fits CTS-Units) -
VOLKRENTS



Flat Shelf Divider A (Fits A-Units) -
DIV197
Flat Shelf Divider CTS (Fits CTS-Units) -
DIV127



A 36" Wire - A36W



A 35" Solid - A36S



1" Tray - 1BC



2" Tray Clear & Gray -
2TC / 2T
Half 2" Tray Clear & Gray -
2.5TC / 2.5T*



2" Dividers Clear & Gray Long -
2DLC / 2DL
2" Dividers Clear & Gray Short -
2DSC / DS



4" Tray Clear & Gray - 4TC / 4T



4" Dividers Clear & Gray Long -
4TDLC / 4TDL
4" Dividers Clear & Gray Short -
4TDSC / 4TDS



4" Basket Clear & Gray -
4BC / 4B
Half 4" Basket Clear & Gray -
4.5BC / 4.5B*



4" Dividers Clear & Gray Long -
4DLC / 4DL
4" Dividers Clear & Gray Short -
4DSC / 4DS



8" Basket Clear & Gray - 8BC / 8B
Half 8" Basket Clear & Gray - 8.5BC / 8.5B*



8" Dividers Clear & Gray Long -
8DLC / 8DL
8" Dividers Clear & Gray Short -
8DSC / 8DS



11" Basket Clear & Gray -
11BC / 11B



11" Dividers Clear & Gray Long -
11DLC / 11DL
11" Dividers Clear & Gray Short -
11DSC / 11DS



* On half size baskets, "short" dividers should be used (eg- 2DSC / 2DS, 4DSC / 4DS, 8DSC / 8DS).

Call Today to Speak to a Representative and Schedule a FREE On-Site Storage Analysis 1.800.393.6090

TERMS AND CONDITIONS

ACCEPTANCE

All orders are subject to acceptance of terms and conditions of sale, regardless of the form in which submitted. All orders are subject to price prevailing at date of shipment.

PAYMENT TERMS

Minimum order is \$50.00. Terms are net 30 days, FOB shipping point (subject to credit approval). Freight, taxes, handling and installation charges are not subject to discount. Credit Cards payments can be made if the total amount is \$5,000.00 or less.

SHIPMENTS

All shipment will be FOB shipping point. If goods are damaged when received, buyer must declare such damages at time of receipt of merchandise, directly on the shipping documents and claim must be filed within 24 hours with the transport company. If after the receipt of merchandise, concealed damage is discovered, buyer must notify delivering carrier requesting an inspection within 24 hours of discovery. The inspection report should be used to support buyer's claim against the carrier. Any claim for damage or shortage must be filed by the buyer with the delivering carrier. Unless a preferred routing is specified at the time of the order, shipment will be made by the best way, transportation prepaid and added to the invoice. For Collect and Third Party shipments, there will be an added 5% handling fee added to your order and the buyer will be fully responsible for all damages and claims.

RETURN POLICY

Merchandise will not be accepted for return unless specifically authorized by DSI, Inc. Products accepted will be subject to 25% restocking charge plus freight. This charge will be reduced to 10% with reorder. Returns must be shipped prepaid and returned within 15 days of the original receipt of shipment. Product must be returned in the original packaging. Items of special design, accessories and parts are not returnable. All goods returned damaged will not be accepted. The original purchaser must provide the following information:

1. Reason for return
2. Original purchase order and invoice from DSI
3. Model number and quantity to be returned

Any credit due customer from return of product will be given in the form of a credit memo that may be used against invoices currently outstanding or future product purchases. Cash credits will not be given, and credits must be used within 90 days from the credit memo date. Errors in processing by DSI, Inc. or defective merchandise are not subject to restocking charge.

LIMITED LIFETIME WARRANTY

All DSI products are backed by a limited lifetime warranty against defect of any kind. The warranty does not cover damage caused by misuse or damage caused by excess of manufacturer's recommended capabilities. All DSI products are guaranteed against defect to the original purchaser. Under this warranty, DSI's obligation is limited to repair or replacement of defective parts. This warranty does not include damage caused by misuse or damage caused by use in excess of recommended capabilities.



BEFORE
AFTER





DISTRIBUTION*Systems*
INTERNATIONAL

PROJECT PLANNERS

- Storage Assessment
- Inventory Audit
- Room Design & Work Flow
- Consultation & Report Out
- Product Installation
- Inventory Transfer
- Labeling & Identifiers

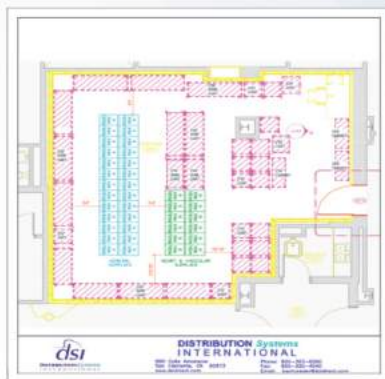

Call DSI for a FREE Storage Analysis

800.393.6090

Visit us at WWW.DSIDIRECT.COM